

Dimension: 1.75" w x 0.40" h

T01 LAMINATE T-MOLDING

Used to fill the gap between two floors of equal height. Most common areas are in doorways or to join two laminate floors.

Used with floors 6-9mm in height.

Surface: Wear resistant laminate
Core Material: Moisture resistant MDF

1

Install the flooring leaving a 1-1/8" gap between the two floors for the t-molding installation.

2

Measure and trim to fit.

3

Center the track between the flooring with 1/4" spacing between the track and floor plank and screw to the subfloor using included screws. *(if subfloor is concrete use rawplugs or masonry screws).*

4

Starting at one end, press the molding into the track inching along the length of the molding. *It will NOT snap in all at once.* You may also use a rubber mallet.

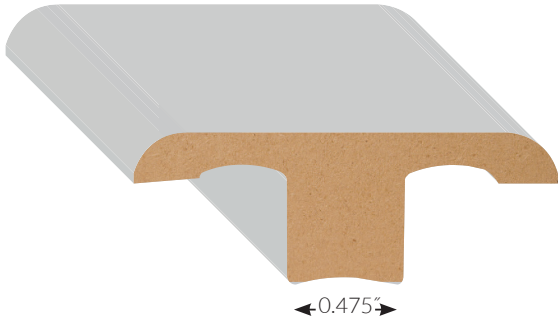

Dimension: 1.75" w x 0.62" h

T02 LAMINATE T-MOLDING

Used to fill the gap between two floors of equal height. Most common areas are in doorways or to join two laminate floors.

Used with floors 10-14mm in height.

Surface: Wear resistant laminate
Core Material: Moisture resistant MDF

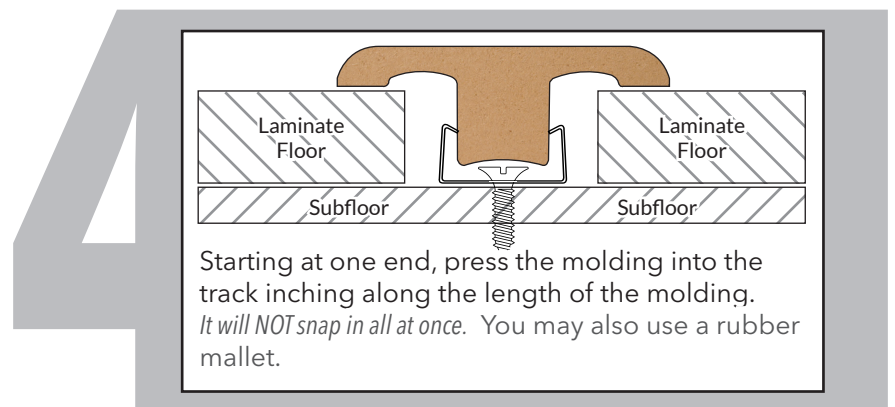
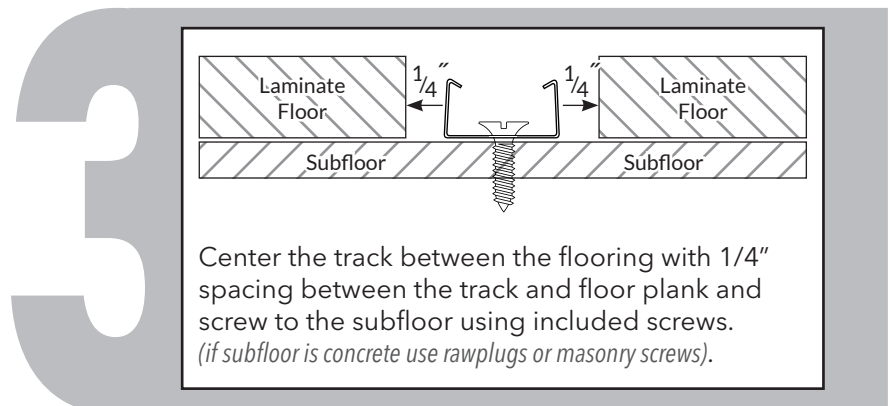
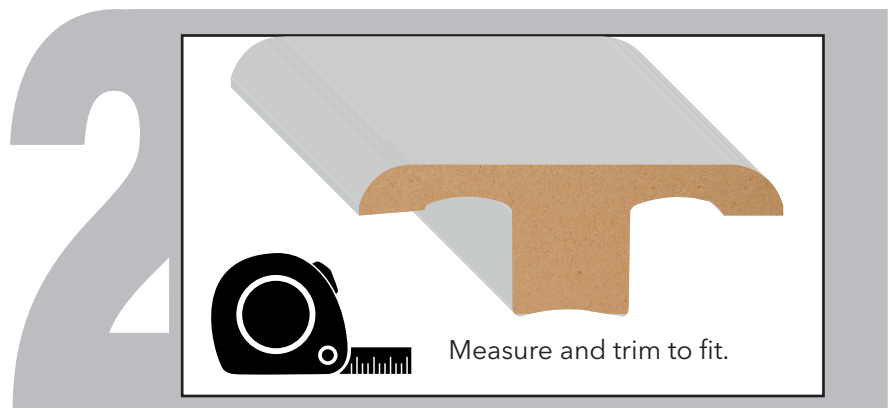
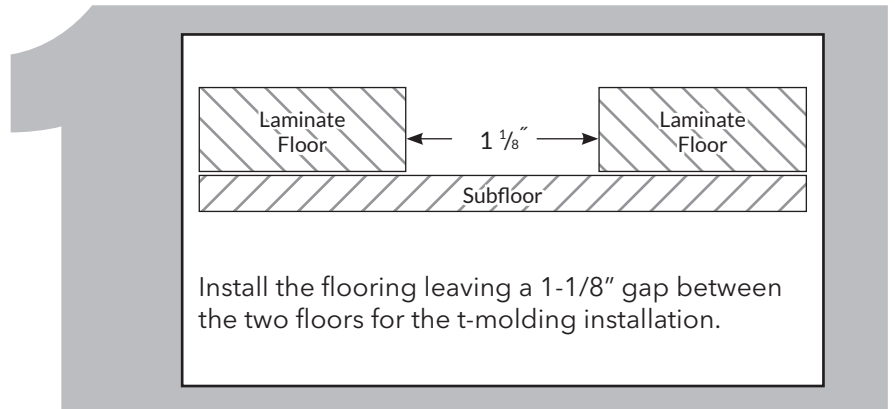

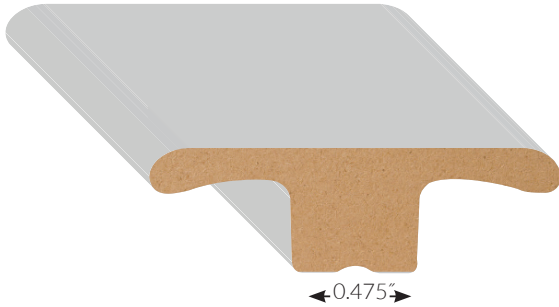

Dimension: 1.5" w x 0.47" h

T05 LAMINATE T-MOLDING

Used to fill the gap between two floors of equal height. Most common areas are in doorways or to join two laminate floors.

Used with floors 7-10mm in height.

Surface: Wear resistant laminate
Core Material: Moisture resistant MDF

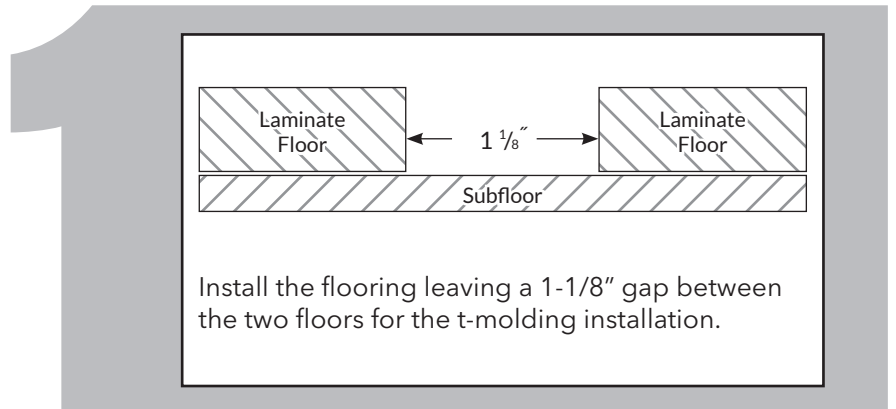

Install the flooring leaving a 1-1/8" gap between the two floors for the t-molding installation.

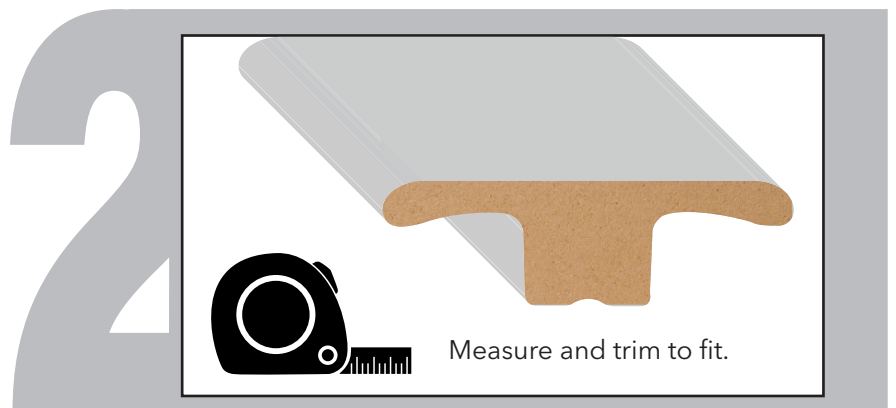

Measure and trim to fit.

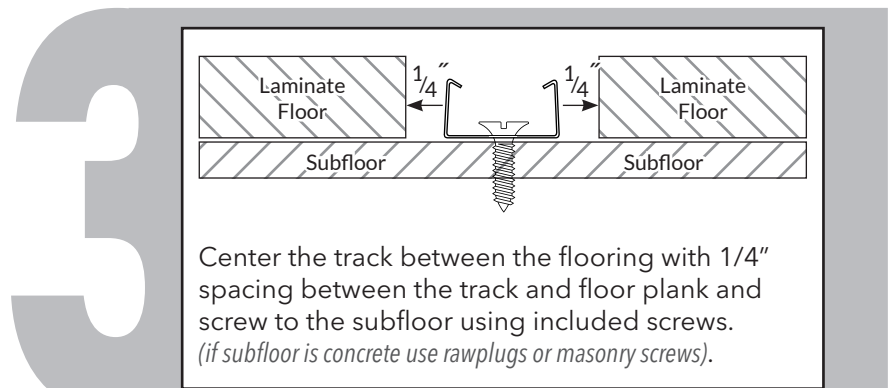

Center the track between the flooring with 1/4" spacing between the track and floor plank and screw to the subfloor using included screws. (if subfloor is concrete use rawplugs or masonry screws).

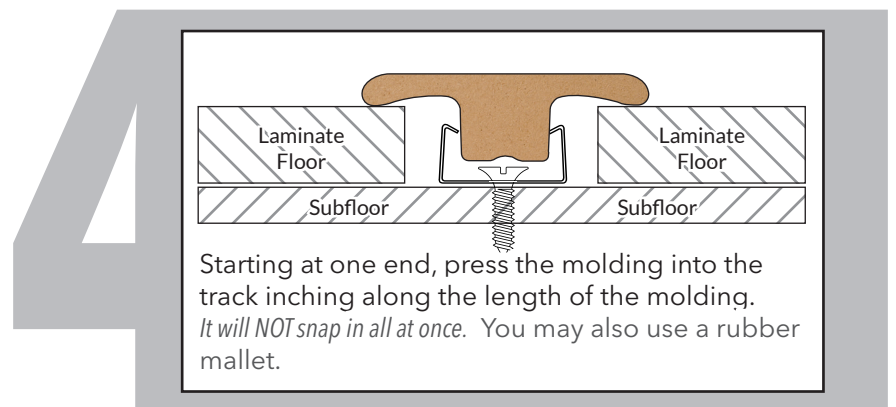

Starting at one end, press the molding into the track inching along the length of the molding. It will NOT snap in all at once. You may also use a rubber mallet.

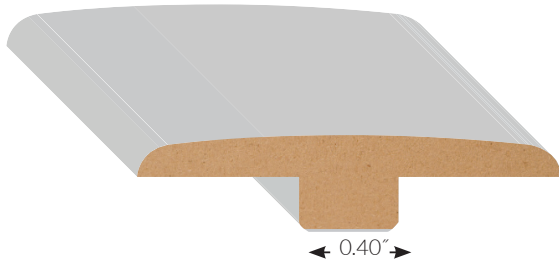

Dimension: 1.7" w x 0.39" h

T06 LAMINATE T-MOLDING

Used to fill the gap between two floors of equal height. Most common areas are in doorways or to join two laminate floors.

Used with floors 7-9mm in height.

Surface: Wear resistant laminate
Core Material: Moisture resistant MDF

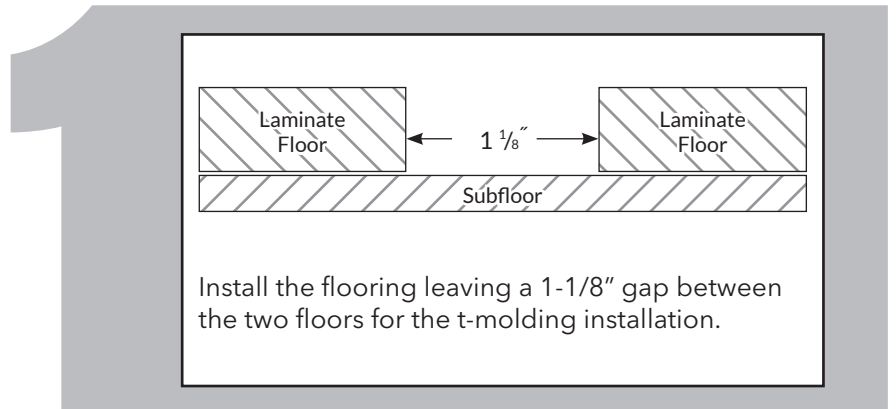

Install the flooring leaving a 1-1/8" gap between the two floors for the t-molding installation.

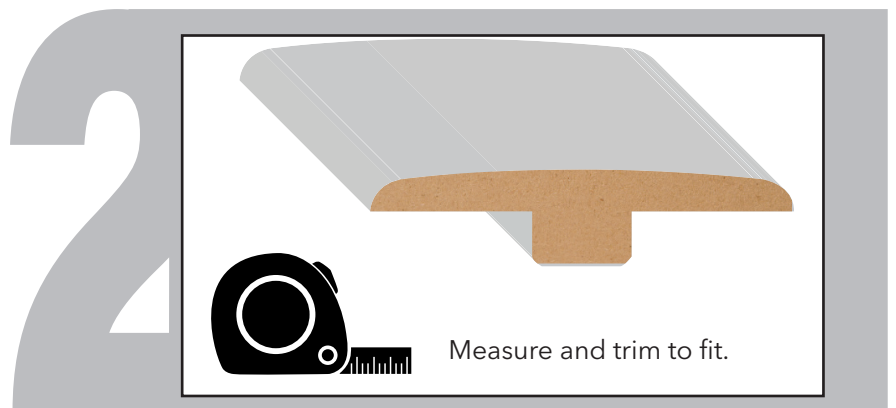

Measure and trim to fit.

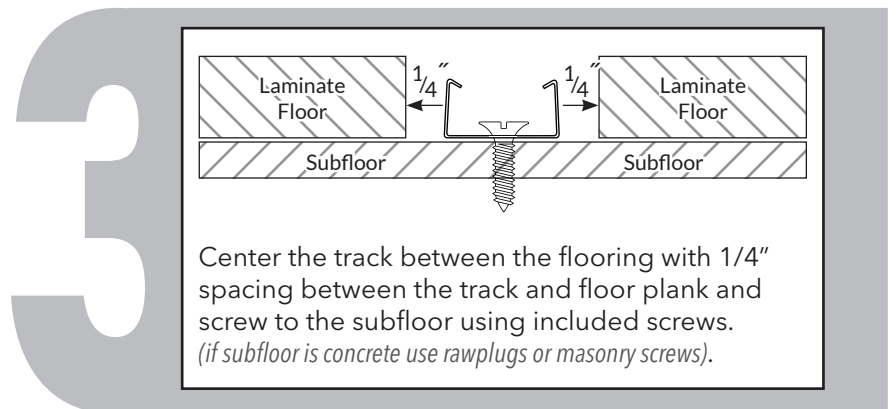

Center the track between the flooring with 1/4" spacing between the track and floor plank and screw to the subfloor using included screws. (if subfloor is concrete use rawplugs or masonry screws).

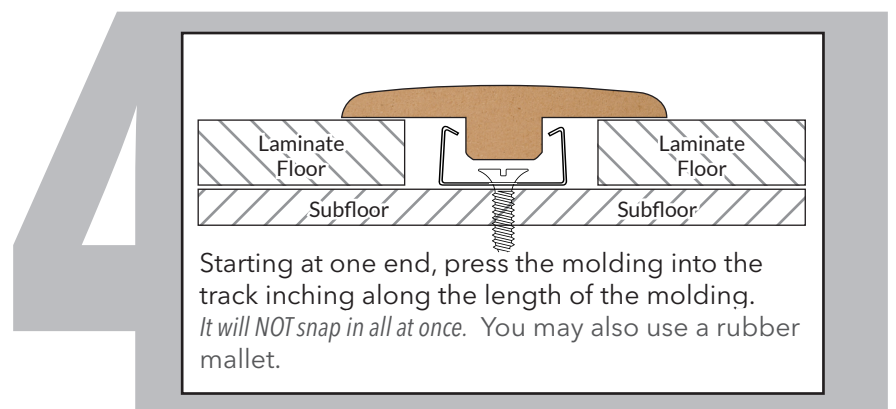

Starting at one end, press the molding into the track inching along the length of the molding. It will NOT snap in all at once. You may also use a rubber mallet.

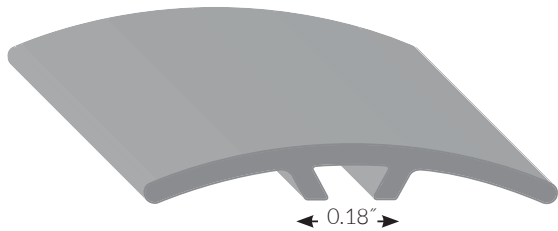

Dimension: 1.59" w x 0.23" h

V-MT

WATERPROOF MULTI-TRIM

Multi-trim can be used for both floors of equal and unequal height. Can also be used as a surface reducer.

Automatically adjusts to varying heights.

Surface: Wear resistant
Core Material: Rigid PVC

1

1 1/8"

Floor Subfloor Floor

Install the flooring leaving a 1 1/8" gap between the two floors for the installation.

Measure and trim to fit.

2

Floor Subfloor Floor Subfloor

Draw a line down the center of the space between floors. Drill 1/4" holes along the line, approximately 15" apart.

3

Slide plugs into the slot on the transition and align with the pre-drilled holes.

4

With a rubber mallet, hammer the plugs into the holes until flush.

Floor Subfloor Floor Subfloor

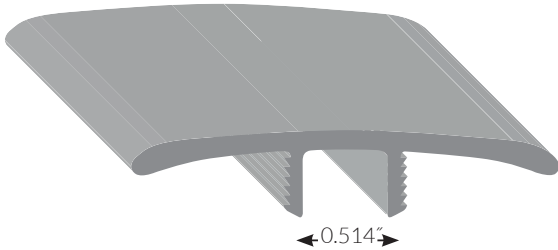

Dimension: 1.82" w x 0.36" h

V-T-10

WATERPROOF T-MOLDING

Used to fill the gap between two floors of equal height.

Used with floors ranging from 8-12mm in height.

Surface: Wear resistant
Core Material: Rigid PVC

1

Install the flooring leaving a 1 1/8" gap between the two floors for the t-molding installation.

2

Measure and trim to fit.

3

Center the track between the flooring leaving a 1/4" spacing between the track and floor planks. Screw track to subfloor using included screws (or glue down to subfloor with construction adhesive).
** May need to use supplied shim*

4

Starting at one end, press the molding into the track inching along the length of the molding. It will NOT snap in all at once. You may also use a rubber mallet.

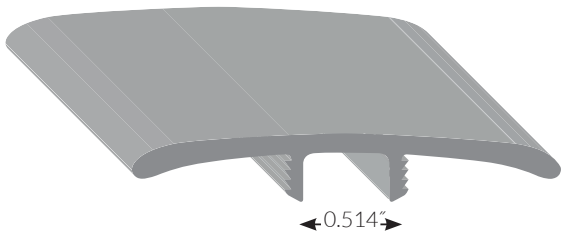

Dimension: 1.77" w x 0.28" h

V-T-14

WATERPROOF T-MOLDING

Used to fill the gap between two floors of equal height.

Used with floors ranging from 2-6mm in height.

Surface: Wear resistant
Core Material: Rigid PVC

1

Install the flooring leaving a 1-1/8" gap between the two floors for the t-molding installation.

2

Measure and trim to fit.

3

Center the track between the flooring leaving a 1/4" spacing between the track and floor planks. Screw track to subfloor using included screws (or glue down to subfloor with construction adhesive).

4

Starting at one end, press the molding into the track inching along the length of the molding. It will NOT snap in all at once. You may also use a rubber mallet.

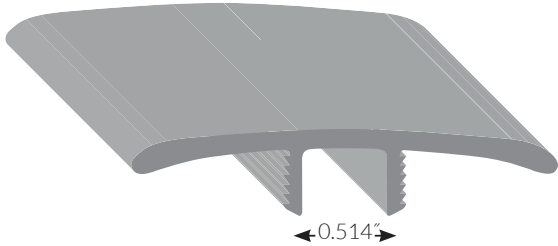

Dimension: 1.82" w x 0.36" h

V-T-18

WATERPROOF T-MOLDING

Used to fill the gap between two floors of equal height.

Used with floors ranging from 6-9mm in height.

Surface: Wear resistant
Core Material: Rigid PVC

1

Install the flooring leaving a 1-1/8" gap between the two floors for the t-molding installation.

2

Measure and trim to fit.

3

Center the track between the flooring leaving a 1/4" spacing between the track and floor planks. Screw track to subfloor using included screws (or glue down to subfloor with construction adhesive).

4

Starting at one end, press the molding into the track inching along the length of the molding. It will NOT snap in all at once. You may also use a rubber mallet.